

FP 150

DIAPHRAGM LIQUID PUMP



FP 150



FP 150

ADVANTAGES

- Low pulsation
- Excellent linearity
- Self-priming and can run dry
- Gentle transfer of sensitive media
- Long lifetime, no maintenance
- Able to transfer aggressive media
- IP 65

POSSIBLE AREAS OF USE

- Inkjet printing
- Medical technology
- Laboratory technology
- Fuel cells
- Semiconductor industry
- And many more

Please visit our website
www.knf.com
 to get more information.

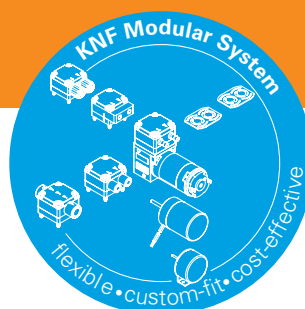

PERFORMANCE DATA		
Series model	FP 150	
Material options	KP	KT
Pump head	PP	PP
Diaphragm	PTFE coated	PTFE coated
Valves / O-rings	EPDM	FFKM / FKM
Flow rate (l/min)	1.5	1.3
Suction height (inHg)	7.8	7.2
Pressure head (psig)	29	29
Permissible media temperature (°C / °F)	5 - 80 / 41 - 176	5 - 80 / 41 - 176
Permissible ambient temperature (°C / °F)	5 - 40 / 41 - 104	5 - 40 / 41 - 104
Protection class	IP 65	IP 65
Weight (kg)	0.8	0.8
ELECTRICAL DATA		
Voltage (V)	24	24
Motor	Brushless DC	Brushless DC
Power (W) start at 5°C ambient	31	31
I (A) start at 5°C ambient	1.3	1.3
I (A) start at 25°C ambient	1.1	1.1
Wires	AWG22	AWG22
Input signal	Vctrl / PWM inverse	Vctrl / PWM inverse
Input signal range Vctrl	0...5 V	0...5 V
Input signal range PWM inverse	100%...0%	100%...0%
VARIOUS		
Dimensions LxWxH (mm)	139x94x77	139x94x77
Hydraulic connections	G 1/8"	G 1/8"

FP 150 KPDCB-4

PERFORMANCE DATA

Series model	Flow rate at atm. pressure (l/min)	Max. suction height (inHg)	Max. pressure head (psig)
FP 150 KPDCB-4	1.5	7.8	29

FP 150 KPDCB-4

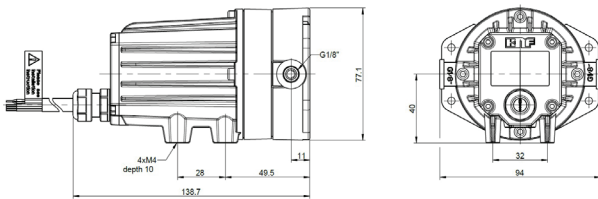

Dimensions in mm

FP 150 KTDCB-4

PERFORMANCE DATA

Series model	Flow rate at atm. pressure (l/min)	Max. suction height (inHg)	Max. pressure head (psig)
FP 150 KTDCB-4	1.3	7.2	29

FP 150 KTDCB-4

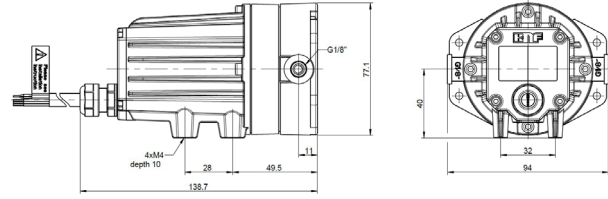

Dimensions in mm

FP 150 KPDCB-4 FLOW RATE

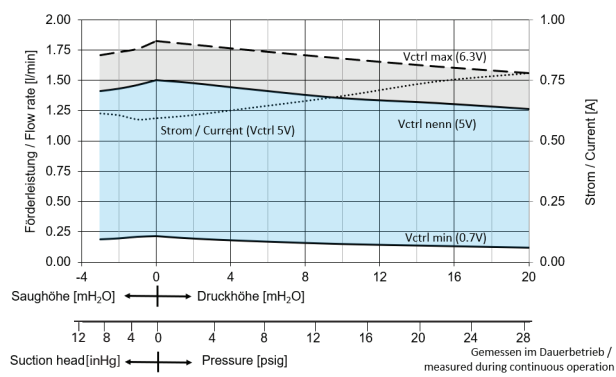

FP 150 KTDCB-4 FLOW RATE

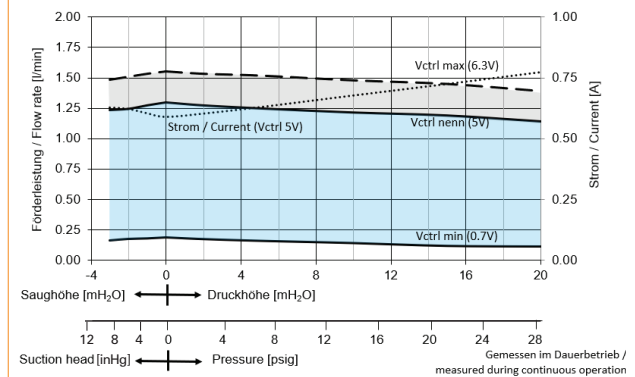



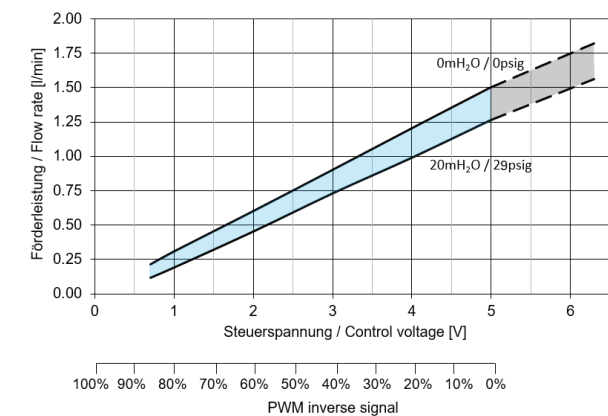

FP 150 KPDCB-4 CONTROL VOLTAGE

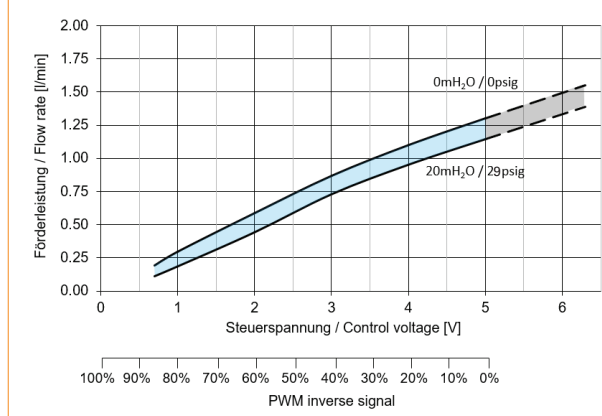

FP 150 KTDCB-4 CONTROL VOLTAGE



OPTIONS		
Description	Illustration	Details
Leakage sensor		The liquid level sensor provides a digital output that denotes the presence of liquid in the motor housing.

ACCESSORIES/SPARE PARTS		
Description	Illustration	Details
Pulsation damper		This versatile pulsation damper reduces hydraulic pressure pulsations and vibrations in hoses and pipes. It helps to remove pulsation which prevents the system from functioning correctly. It also protects instrumentation connected after the pump.
Mounting plate		Enabling additional mounting options. Screws included in the set.
Mounting clamp		Additional fixing possibility by means of a pipe clamp on the pump.

The performance values for the series models shown on this data sheet were determined under test conditions. The actual performance values may differ and depend in particular on the usage conditions and therefore on the specific application, on the parameters of the components involved in the user's system and on any technical modifications carried out which deviate from the standard configuration or the as delivered condition.

If individual designs have been created for specific customers on the basis of series models, other technical performance data may apply. Before operation begins, the relevant operating instructions and/or assembly or installation instructions should be read and the safety information contained in these instructions should be noted. KNF reserves the right to make changes to the product and the associated documentation without prior notice to the customer



www.knf.com