

UNF 1.300 EX DIAPHRAGM LIQUID PUMP



UNF 1.300 TT | EX

ADVANTAGES

- For use in Class 1, Div 1, Groups C&D hazardous location areas
- High pressure of 88 psig
- Self priming, dry running and durable
- High chemical resistance
- Low maintenance
- Available with integrated overpressure relief valve version .27)

POSSIBLE AREAS OF USE

- Solvent transfer
- Oil & Gas
- Chemical
- Analysis
- Pharmaceutical processes

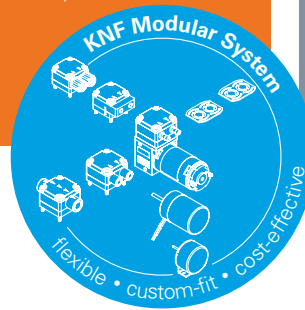

* food grade conformity according to the standard NSF/ANSI 169

Please visit our website
www.knf.com
to get more information

PERFORMANCE DATA			
Series model	UNF 1.300 EX		
Material options	KT	TT	
Pump head	PP	PVDF	
Diaphragm	PTFE	PTFE	
Valves	FFKM	FFKM	
Flow rate at atm. pressure (l/min)	3		
Suction height (mH ₂ O/ftH ₂ O)	3/10		
Pressure head (mH ₂ O/psig)	60/88		
Permissible ambient air (°C / °F)	5 - 40 / 41 - 104		
Permissible liquid temperature (°C / °F)	5 - 80 / 41 - 176		
Weight (kg/lbs)	14/30		
Maximum viscosity (cSt)	150		
ELECTRICAL DATA			
Operating voltage, frequency (V),(Hz)	115/230, 60		
Power consumption (W)	800		
I max. Start (A)	7.0/3.5		
HazLoc rating, temp code & certification	Class 1, Div 1, Groups C&D	T3B	UL / CSA

UNF 1.300 EX

PERFORMANCE DATA

Series model	Flow rate at atm. pressure (l/min)	Max. suction height (mH ₂ O/ftH ₂ O)	Max. pressure head (mH ₂ O/psig)
UNF 1.300_T EX	3	3/10	60/88

UNF 1.300 EX

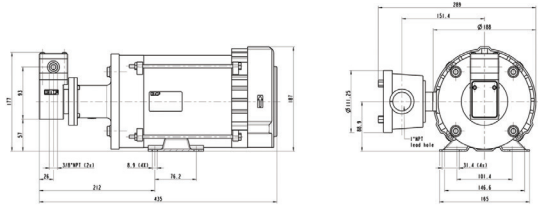

Dimensions in mm

UNF 1.300 EX FLOW CURVE

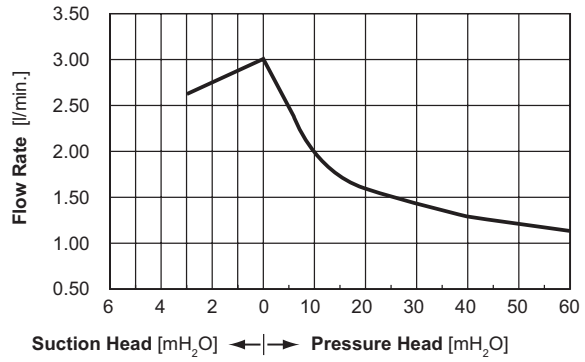

OPTIONS

Description	Illustration	Part No.	Details
Motors			Various voltage and hazardous location area rating options
Hydraulic connections			G / NPT internal thread



National Sanitary Foundation (NSF)

This certification will confirm that all of the pumps with the code .51 are certified for use with foods/consumables.



ATEX-explosion proof motors

For pumping liquids in explosive atmospheres, we offer an alternate version of the NF1.300 EX with full ATEX certification.

ACCESSORIES

Description	Illustration	Part No.	Details
Diaphragm pressure control valve (version .27)			The pressure control valve can be used for a more accurate control of flow against a fluctuating back pressure, metering into a vacuum and from a pressurized system.
Pulsation damper			This versatile pulsation damper reduces the vibration in hoses and pipes and helps remove pulsation which can prevent the system from functioning correctly.

The performance values for the series models shown on this data sheet were determined under test conditions. The actual performance values may differ and depend in particular on the usage conditions and therefore on the specific application, on the parameters of the components involved in the user's system and on any technical modifications carried out which deviate from the standard configuration or the as delivered condition.

If individual designs have been created for specific customers on the basis of series models, other technical performance data may apply. Before operation begins, the relevant operating instructions and/or assembly or installation instructions should be read and the safety information contained in these instructions should be noted. KNF reserves the right to make changes to the product and the associated documentation without prior notice to the customer.



www.knf.com